

Concrete Floor Standing External Fountain

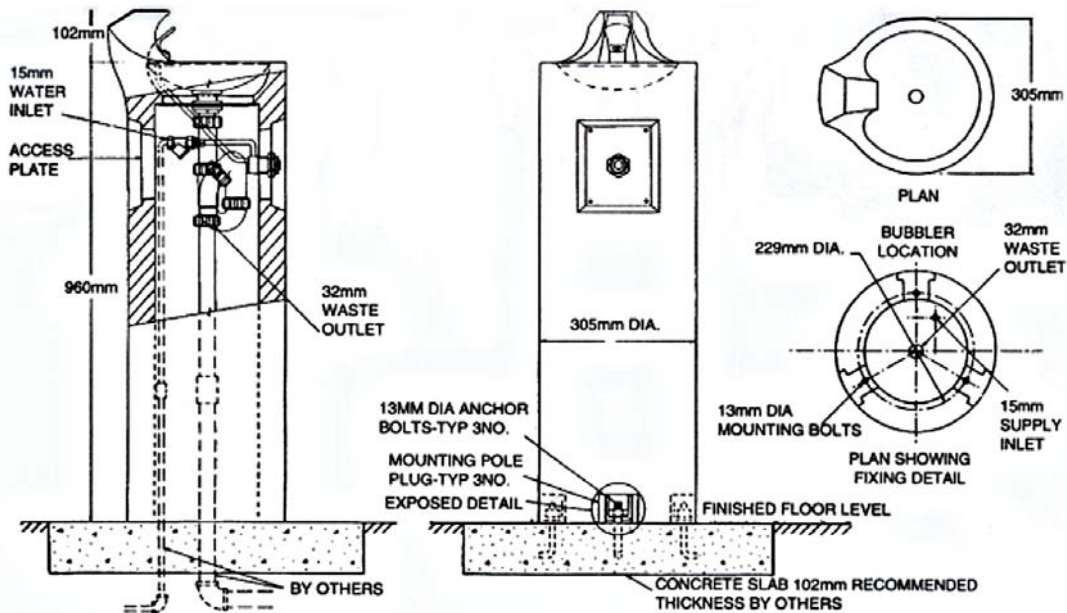

Concrete Floor Standing External Fountain

Specially designed for outdoor use in parks, playgrounds and golf courses. A heavy chrome-plated projector protected by a vandal resistant guard integral with precast stone body and operated by a remote push button self-regulating valve.



Construction:

Finished in precast stone exposed aggregate to give an attractive but durable appearance with a high degree of vandal resistance. Access plate fixed with tamper proof bolts.

Services:

Water inlet: 15 mm ($\frac{1}{8}$ " BSP) brass line strainer.
Waste: 32 mm multi-fit trap.

Packaging:

Dimensions: 1110 x 380 x 380 mm
Weight: 90 kgs.

CAUTION

Drinking Fountains On Outside Locations

During winter when temperatures may reach freezing point, it is advisable to drain the water system to prevent damage to the bubbler cartridge.

Ideally, a drain-cock should be fitted downstream of the shut-off cock and before the fountain.

To drain the system:-

1. Close off the shut-off cock and drain off at the drain-cock holding the push button in the open position until all the water has drained away.
2. Close off the drain-cock.

If a drain-cock is not available, the water can be drained in the same manner at the removable plug on the line strainer located inside the fountain.

Please note that frequent use of this item for draining purposes can lead to leakages and it should be considered as a temporary measure until such time that a drain-cock can be fitted.



Water Flow Adjustment

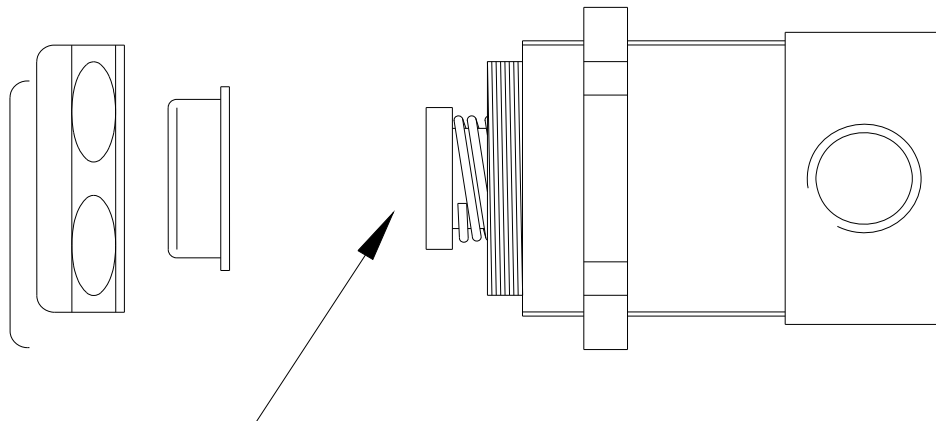

ADJUST THE WATER FLOW BY ROTATING THE SLOT IN THE WHITE HEADED SCREW LOCATED IN THE PUSH BUTTON